

east

东隅 BEIJING

EAST Room (325 sq ft / 30 sqm)

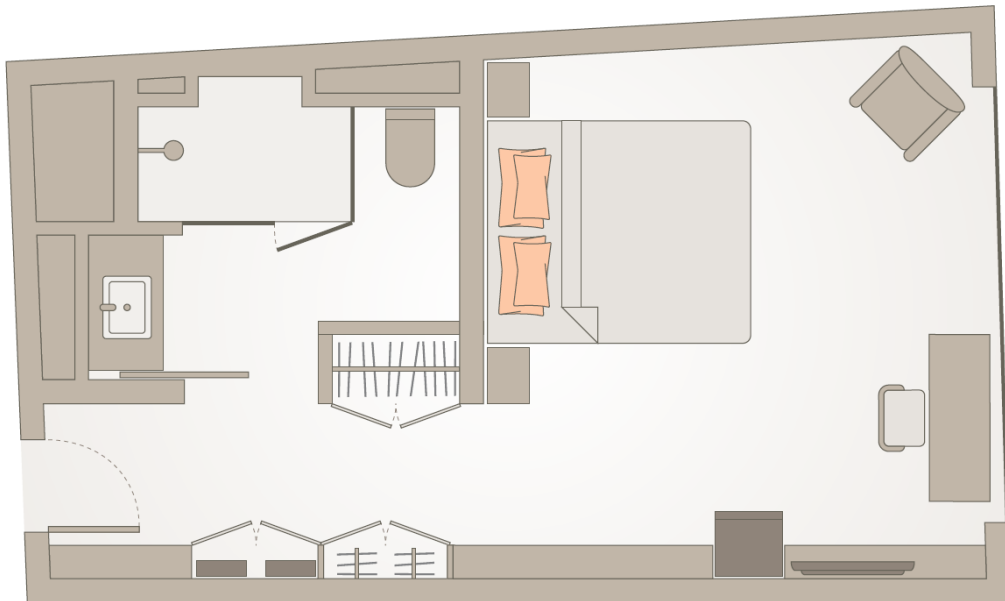

Guest Rooms and Suites

From our EAST Rooms, you can enjoy scenic views of Beijing's 17-hectare open park, complimented with floor-to-ceiling windows. Familiar conveniences are also featured such as the walk-in rainfall shower, iPod touch and audio docking system, flat screen television, digital safe and a comfortable work station. All rooms are designed to ensure that you feel right at home. All EAST Rooms come with king-sized beds.

Room Features

- + King- sized bed
- + Comfortable down bedding
- + Walk-in rainfall shower
- + Bathroom amenities by Hydro Basics
- + iPod dock and audio docking system
- + Complimentary Wi-Fi and wired broadband internet access
- + Complimentary coffee and tea
- + Hair- dryer
- + Iron and ironing board
- + Safety box
- + Flat screen TV
- + 24-hour room service
- + Multi-scene lighting
- + Hardwood floors
- + Blackout blinds with sheer curtains

EAST, Beijing 北京东隅

No. 22 Jiuxianqiao Road,
Chaoyang District, Beijing, 100016
北京市朝阳区酒仙桥路22号

T +8610 8426 0888
www.east-beijing.com