

# east

东隅 BEIJING

## EAST Corner Room

(750 sq ft / 70 sqm)

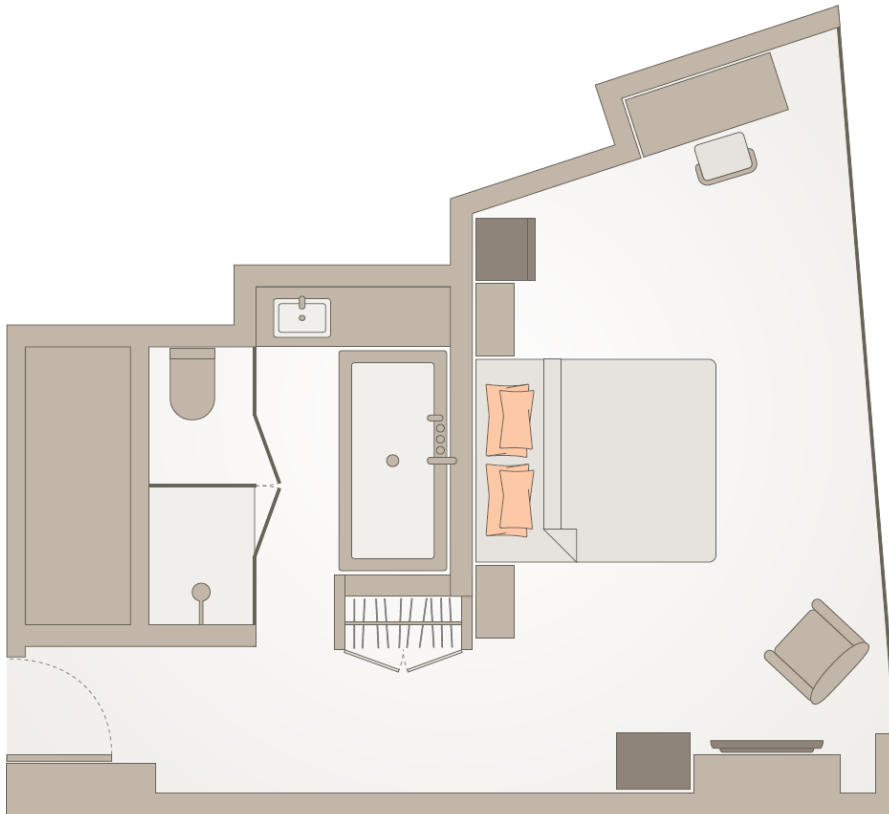

### Guest Rooms and Suites

All spacious EAST Corner Rooms are approximately 70 sqm (750 sqft), offering views of Beijing's 17-hectare open park. These rooms feature a king-sized bed, walk-in rainfall shower and a relaxing bath with amenities by Canadian lifestyle brand Hydro Basics and Australian-designed skin and hair care brand Appelles®. Separate seating and dining areas are perfect for stretching out during longer stays in Beijing. Other in-room facilities include a Nespresso coffee machine, complimentary Wi-Fi, international power sockets and of course, 24-hour room service.

### Room Features

- + King-sized bed
- + Comfortable down bedding
- + Walk-in rainfall shower and bathtub Bathroom Amenities by Appelles® and Hydro Basics
- + iPod dock and audio docking system
- + Complimentary Wi-Fi and wired broadband internet access
- + Nespresso coffee machine and tea
- + Hair-dryer
- + Iron and ironing board
- + Safety box
- + Flat screen TV
- + 24-hour room service
- + Multi-scene lighting
- + Hardwood floors
- + Blackout blinds with sheer curtains

### EAST, Beijing 北京东隅

No. 22 Jiuxianqiao Road,  
Chaoyang District, Beijing, 100016  
北京市朝阳区酒仙桥路22号

T +8610 8426 0888  
www.east-beijing.com